

## SAMPLE COMMERCIAL SITE

### COMPANY NAME

CLIENT NAME

CLIENT NUMBER

CLIENT EMAIL

REFERENCE # :

DATE

**NET BALANCE:**

**3.791 IMPORT (CY)**

**GRADED AREA:**

**1.21 (AC)**

**52,639 (SF)**

**SUMMARY**

Name	Area (SF)				Raw Volumes (CY)		Comp/Ratio		Compact (CY)		Net	Balance(CY)
	Total(SF)	Cut(SF)	Fill(SF)	OnGrade(SF)	Cut(CY)	Fill(CY)	Cut	Fill	Cut(CY)	Fill(CY)	Balance(CY)	Change / .1'
Site	52,639	2,831	48,142	1,666	111	3,902	1.00	1.00	111	3,902	3,791	Import 191

Subgrade Sections	Plane Area(SF)	Slope Area(SF)	Depth (FT)	Volume (CY)
AC Pavement	8,510	8,516	1.167	368
Bioretention	747	747	2.500	69
Driveway Entrance	312	312	1.000	12
Driveway Lots	1,265	1,272	1.000	44
Pervious Pavers	5,329	5,331	1.927	380
Sidewalk	2,906	2,912	0.833	90
<b>Total</b>	<b>19,069</b>	<b>19,090</b>		<b>963</b>

Removal Items	Plane Area(SF)	Slope Area(SF)	Depth (FT)	Volume (CY)
Asphalt Demolition	24,170	24,185	0.250	224
Building Demolition	16,833	16,835	0.500	312
Concrete Demolition	2,092	2,101	0.333	25
<b>Total</b>	<b>43,095</b>	<b>43,121</b>		<b>561</b>

**Notes**

**Existing Layer:**

Data calculated from the following file(s):

- Sheet C1.0 from "2001 Tarob Court-Combined Grading, Improvement, Landscape and Joint Trench Plans.pdf" (plot date 9/1/22)

**Design Layer:**

Data calculated from the following file(s):

- Sheets C4.1, C4.2, C6.3, C8.1, C8.2 from "2001 Tarob Court-Combined Grading, Improvement, Landscape and Joint Trench Plans.pdf" (plot date 9/1/22)

**Subgrade Sections:**

01. AC Pavement 4"/10" (C3.0)
02. Bioretention 18"/12" (C5.2)
03. Driveway Entrance 6"/6" (assumed)
04. Driveway Lots 6"/6" (assumed)
05. Pervious Pavers 3.125"/2"/4"/14" (C5.2)(pavers assumed)
06. Sidewalk 4"/6" (C3.0)

**Removal Items:**

Demolition was removed before volumes were calculated and needs to be stockpiled or off-hauled.

01. Asphalt Demolition 3" (assumed)
02. Building Demolition 6" (assumed)
03. Concrete Demolition 4" (assumed)

**Notes:**

01. Existing Building was assumed to have a FF of 49.2
02. Buildings were entered at pad grade per plans (including garage)
03. No Offsite was calculated due to no Offsite plans were provided

Name	Area (SF)				Raw Volumes (CY)		Comp/Ratio		Compact (CY)		Net	Balance(CY)	
	Total(SF)	Cut(SF)	Fill(SF)	OnGrade(SF)	Cut(CY)	Fill(CY)	Cut	Fill	Cut(CY)	Fill(CY)	Balance(CY)	Change / .1'	
AC Pavement	8,510	641	7,505	364	10	474	1.00	1.00	10	474	464	Import	31
Bioretention	747	663	42	42	58	0	1.00	1.00	58	0	58	Export	3
Building 1	9,918	36	9,870	12	1	824	1.00	1.00	1	824	823	Import	37
Building 2	9,918	0	9,918	0	0	864	1.00	1.00	0	864	864	Import	37
<b>Subtotal:</b>	<b>19,836</b>	<b>36</b>	<b>19,788</b>	<b>12</b>	<b>1</b>	<b>1,688</b>	<b>1.00</b>	<b>1.00</b>	<b>1</b>	<b>1,688</b>	<b>1,687</b>	<b>Import</b>	<b>74</b>
Driveway Entrance	312	0	297	15	0	11	1.00	1.00	0	11	11	Import	1
Driveway Lots	1,278	0	1,278	0	0	71	1.00	1.00	0	71	71	Import	0
<b>Subtotal:</b>	<b>1,590</b>	<b>0</b>	<b>1,575</b>	<b>15</b>	<b>0</b>	<b>82</b>	<b>1.00</b>	<b>1.00</b>	<b>0</b>	<b>82</b>	<b>82</b>	<b>Import</b>	<b>1</b>
Landscape	13,721	1,411	11,513	797	41	1,300	1.00	1.00	41	1,300	1,259	Import	51
Pervious Pavers	5,329	19	4,897	413	0	95	1.00	1.00	0	95	95	Import	20
Sidewalk	2,906	61	2,822	23	1	263	1.00	1.00	1	263	262	Import	11
<b>Site Total</b>	<b>52,639</b>	<b>2,831</b>	<b>48,142</b>	<b>1,666</b>	<b>111</b>	<b>3,902</b>	<b>1.00</b>	<b>1.00</b>	<b>111</b>	<b>3,902</b>	<b>3,791</b>	<b>Import</b>	<b>191</b>

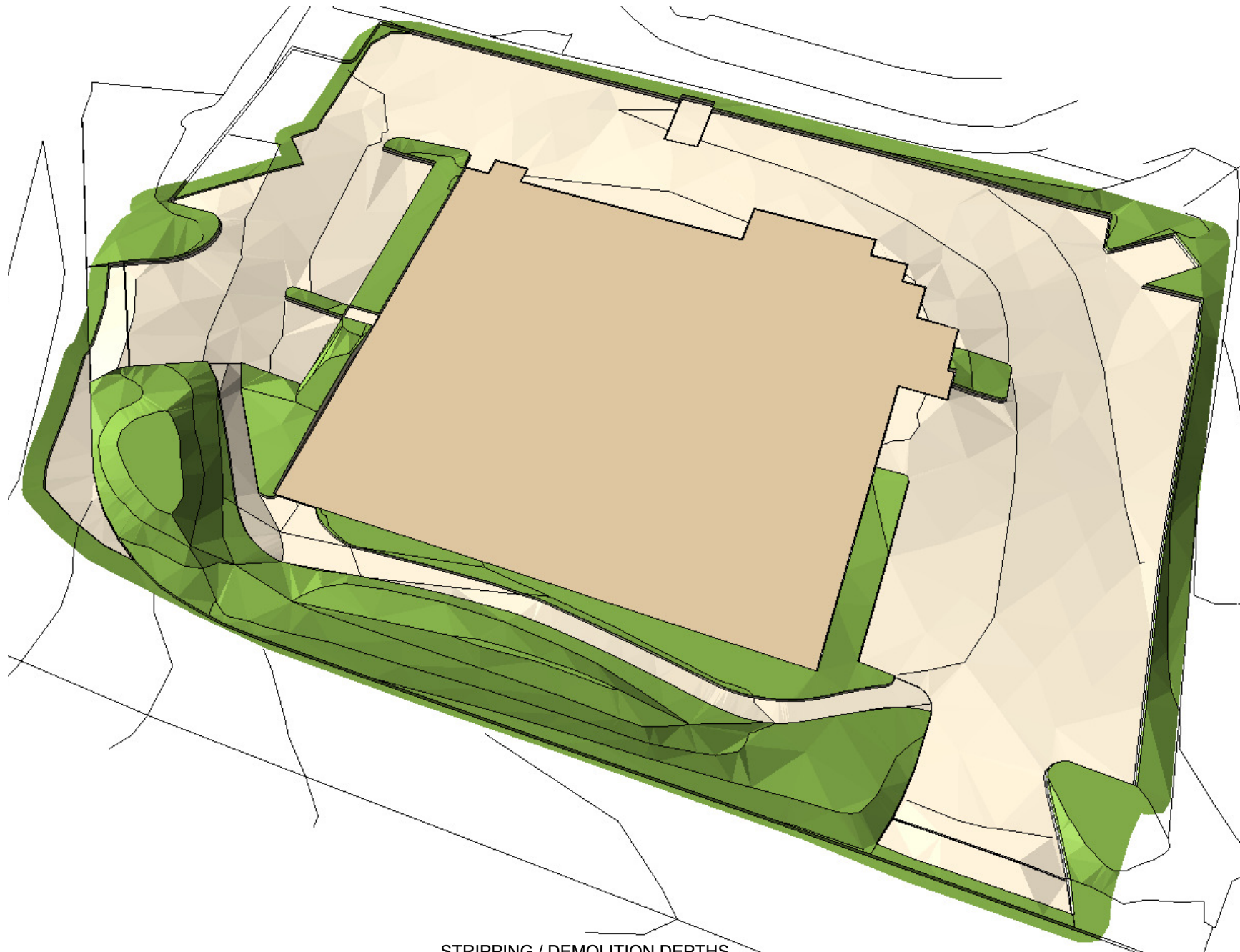

STRIPPING / DEMOLITION DEPTHS

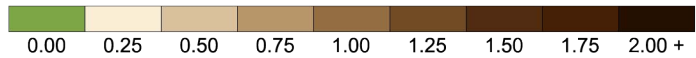

**SAMPLE COMMERCIAL SITE**

**EXISTING**



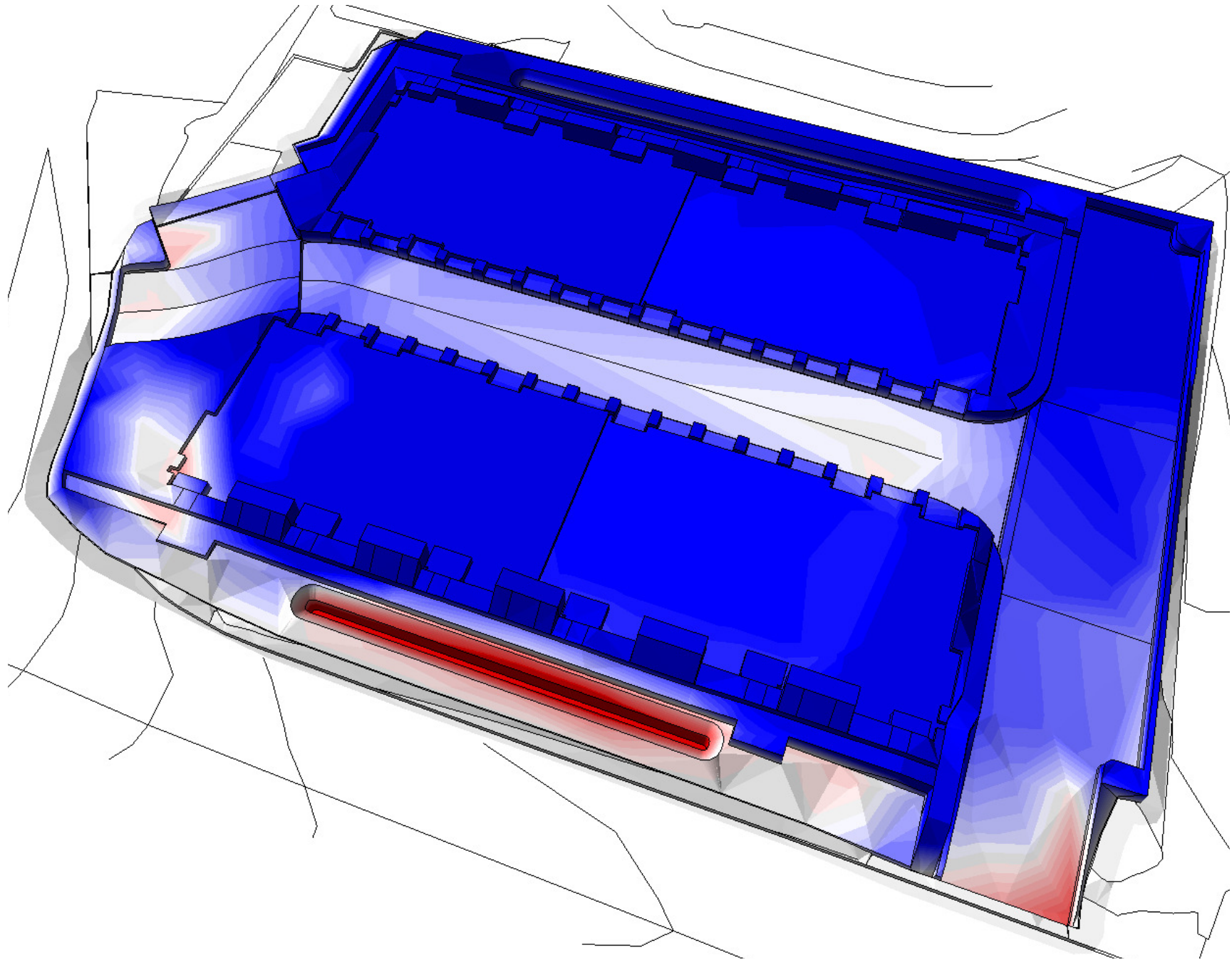

**SAMPLE COMMERCIAL SITE**

**PROPOSED**



